

SALT LAKE COMMUNITY COLLEGE
FASHION INSTITUTE FASH 1680
DIGITAL PATTERN MAKING

Instructor's Contact Information:

MATERIALS AND SUPPLIES

- Fabric and tools to complete sewing projects as assigned.
- Patternmaking Book (the one you used in FASH1100)
- Pins and Measuring Tape
- Bobbin / Thread
- Flash Drive
- Pencils, Pens
- Seam ripper /Tiny scissors
- Optional: Windows laptop, Computers may be checked out from Redwood Campus Library
- More as Needed

COURSE DESCRIPTION

This course introduces the use of industry standard CAD software for Fashion Designers. Using Gerber AccuMark V10, the student will learn how to digitize existing pattern pieces for apparel production purposes, as well as create new patterns and make numerous pattern manipulations and adjustments with AccuMark software. Class structure will consist of a demonstration and lecture followed by lab time supervised by instructor. Out of class lab time will be available for students to practice and complete homework assignments the software. Many assignments, including the Final project will be plotted out and sewn.

PREREQUISITES: Patternmaking 1100 & Beginning sewing or equivalent

COURSE GOALS & LEARNING OBJECTIVES

- True and Balance all patterns
- Maintain Fit and Accuracy.
- Familiarize students with industry standard Gerber AccuMark software.
- Successfully perform a wide range of pattern manipulations and adjustments using PDS.
- Digitize existing patterns for use in PDS – Pattern Design System
- Plot Pieces
- Create new pattern pieces and styles in PDS from basic slopers provided.
- Create Patterns from measurements or spec sheets.
- Create Models – Style Piece Lists
- The importance of sample testing before production.

COURSE REQUIREMENTS

Your grade will be determined on a point system by class participation and attendance, weekly quizzes, class projects, practical exams, written exams a Final Project and E- portfolio. Professional presentation, level of difficulty and neatness count.

Attendance is required for this class as instruction will be given pertinent to class material and assignments and will not be repeated. Lectures may or may not represent information acquirable from the readings or other sources. Therefore, if a student misses a class, it is his/her responsibility to make arrangements for notes from a peer. Attend class prepared to participate in discussions from Lessons. 150 Points.

- Complete weekly assignments and quizzes.
- Successfully pass the midterm 100 points and final exam 200 points.
- Exams are comprised of multiple choice, matching and fill in the blank and practical use of skills.
- Class projects:
 - T-Shirt from measurements, based on a rectangle. Test samples.
 - Decorative T- Shirt with sample.
 - 8-16 gore skirt repeating pattern based on a circle, with sample of 3 or more gores.
 - Princess Dress
 - Pockets
 - 3 Balanced skirts as assigned
 - Blouse with facings, sleeves and collar with sample.
 - Fully lined jacket with collar and lapel
 - Final Project patterns, samples.
 - Truing and balancing all work.
 - Piece Lists (models) must be connected to each Pattern no credit without
 - Spec Sheets as requested
 - E-Portfolio

Note: Late projects will be accepted the following class period with a deduction of 20%. After that they will be accepted for half credit-no exceptions. On time assignments may only be turned in during the class period in which they are due.

Assignments are open to changes by the teacher, pay attention.

Grade % Scale:

A (100-93),
A-(92-90),
B+(89-87),
B(86-83),

B-(82-80),
C+(79-77),
C(76-73),
C-(72-70),

D+(69-67),
D(66-63),
D-(62-60),
E(59-0).

CLASS SCHEDULE AND HOMEWORK

The schedule will be followed as closely as possible; however, some modifications may be necessary during the semester. Students should be prepared to spend time using the software outside of class to complete homework assignments. Homework for each week will be demonstrated during class, and assignment details will be given out in adequate time for preparation. You should be prepared to spend time outside of class completing homework as assigned. Practical assignments will be explained in class. When complete they will be plotted and sewn to test for fit design and spec accuracy. Class presentation, discussion and insights will be involved.

FASH 168o COURSE LEARNING OUTCOMES

After completing this course, students will be able to:

- Demonstrate substantive knowledge of the use of Gerber software to create, alter and adjust clothing patterns.
- Demonstrate substantive understanding of truing and balancing a pattern with Gerber software.
- Demonstrate and apply knowledge of entering and creating t-shirt patterns based on a rectangle using a measurement spec sheet.
- Demonstrate the ability to digitize an existing pattern.
- Demonstrate the ability to plot patterns.
- Demonstrate an understanding of the importance of correct test samples prior to production.
- Demonstrate an understanding of the importance of, and the ability to make patterns that are easy to sew in production by adding notches, pre-mitering corners, comparing lengths and responding to sample sewers.
- Demonstrate effective communication in oral reports, visual presentations, and class peer reviews and discussions.
- Demonstrate the ability to maintain correct fit and balance throughout the pattern manipulation to final design process.

SLCC is committed to fostering and assessing the following student learning outcomes in its programs and courses:

1. Acquire Substantive Knowledge
2. Communicate Effectively
3. Develop Quantitative Literacy
4. Think Critically and Creatively
5. Civic Engagement
6. Work Professionally and Constructively
7. Develop Computer and Information Literacy
8. Lifelong Wellness

Cheating Policy:

Students found cheating on an exam will be given a zero for the first offense. If it happens again, the student will receive an E for the entire course. There will be no tolerance for cheating.

Incompletes:

An incomplete is a conditional grade given only in extraordinary cases where a student has completed a major portion of the class but is unable to complete course work due to circumstances beyond their control such as major illness/injury or a death in the family. Written documentation from your physician will be required.

Student Code of Conduct:

“As a member of the academic community, students enjoy privileges and share obligations of the larger community of which Salt Lake Community College is a part. With membership in this community comes an obligation. The obligation is an acceptance of a code of civilized behavior.” Academic Honesty will be strictly enforced in this course.

Any behavior deemed unethical or that does not abide by reasonable academic honesty will result in action by the professor.

Please visit http://www.slcc.edu/policies/docs/Student_Code_of_Conduct.pdf for more information on SLCC's Academic Honesty Policies and Procedures.

E-portfolio: Assignment Details

During the upcoming semester, you will choose an assignment, one that you feel is your best work of the semester. Take a photo and upload it into your ePortfolio. Write a “Reflection” answering the following questions:

Please be creative in your presentation and in writing your “Reflection.”

- 1) What was the assignment you chose for your e-portfolio project?
- 2) Why did you choose this project?
- 3) What did you learn from completing this project?
- 4) How do you see yourself potentially using the skills and information you acquired from this project in your future career?

Each student enrolled in General Education courses at SLCC maintains a General Education ePortfolio. Instructors in every Gen Ed course will ask you to put at least one assignment from the course into your ePortfolio, and accompany it with reflective writing. Additionally, it is a requirement in this class for you to add 1 assignment from this course to your ePortfolio; assignment details can be found in Canvas and will be discussed in greater detail during the semester.

If you don't already have an ePortfolio, please set one up (see below for instructions). Your ePortfolio will allow you to include your educational goals, describe your extracurricular activities, and post your resume. When you finish your time at SLCC, your ePortfolio will then be a multi-media showcase of your educational experience.

For detailed information visit <http://www.slcc.edu/gened/eportfolio>.

Starting an ePortfolio

Five Important Steps for Creating an ePortfolio:

Step One: Get Informed.

- Go to www.slcc.edu/gened/eportfolio and watch the introductory video.
- Click on the “Student Support Site” tab and look at that material.
- Click the various tabs, read carefully through the ePortfolio information located there, which will answer many of your questions.

Step Two: Set up your Digication site.

Step Three: Watch the Video Tutorial or Attend a Free Workshop.

Step Four: Build Your ePortfolio.

Step Five: Enter the Address of Your ePortfolio into Your MyPage.

*Drop-in ePortfolio Support Lab / You may visit one of our ePortfolio Support Labs. Staff there can help you get started, organize your ePortfolio properly, connect to Learning Outcomes, link your ePortfolio URL to MyPage, and help you showcase your coursework in meaningful and dynamic ways.

For more information go to: <http://eportresource.weebly.com/howto-get-started.html>

ADA Statement:

Emergency Evacuation Procedure and School Cancellation Policy:

In the event of an emergency requiring us to exit the building, please use the stairs located nearest to the classroom and exit the building promptly. If you require additional assistance, please see me as soon as possible to discuss your needs.

SLCC Emergency Information:

“If you SEE something, SAY something” If you witness:

- Theft
- Accident
- Violence
- Suspicious Activity
- Life, Safety or Emergency - Call 911!

If a power outage occurs such that the professor cancels that specific class, please do not assume the rest of your classes are cancelled. Normally, power is restored within half an hour. To get accurate information on how long an outage is expected to last, and whether the College president is canceling classes, call the information hotline from a campus phone by dialing “INFO” (4636). From a cell phone or other outside phone, call 801-957-INFO (801-957-4636).

Title IX Information: 20 U.S.C.A. Section 1681 (a): TITLE IX

“No person in the United States shall, on the basis of sex, be excluded from participation in, be denied benefit of, or be subjected to discrimination under any education program or activity receiving federal funds.”

Examples of violations (but not limited to):

- Sexual advances, requests for sexual favors and sexually motivated physical conduct
- Overt or subtle pressure for sexual activity
- Sexually offensive verbalization including remarks, “teasing”, slurs, and innuendo
- Repeated inappropriate jokes or comments about sex or gender specific traits
- Conduct that is demeaning or derisive and occurs substantially because of one’s gender
- Sexual assault
- Sexual Violence
- Gender based disparate treatment

Violations can occur in any college environment, such as (but not limited to):

- | | |
|-----------------|--------------------|
| • Field Trips | • Athletics |
| • Classrooms | • Transportation |
| • Student Clubs | • On Campus Events |

If you have questions or concerns regarding your rights or responsibilities, or if you would like to file a Title IX complaint please contact:

- Students : Dr. Marlin Clark, Dean of Students, 801-957-4776, STC 276 A (Redwood)
- Employees or Community members: Ken Stonebrook, Title IX & Discrimination Manager, 801-957-5027, AAB 211G (Redwood)
- Online Reporting Form <http://www.slcc.edu/eoo/title-ix/complaint.aspx>

Salt Lake Community College has a strong prohibition against RETALIATION! The college does not tolerate acts of retaliation against anyone for engaging in filing a complaint or participating in an investigation.

SEVERE WEATHER CONDITIONS:

If weather conditions are severe enough to cause concern regarding the open/closed status of the college, everyone can get timely and accurate information by calling the Information Hotline, 801-957-INFO or 801-957-4636. Information is posted on this hotline at 5:00 a.m. and will be updated as conditions change. Major media may also provide information about school closures.

RECORDING OF HEARINGS, MEETINGS AND ACADEMIC INSTRUCTION:

Students are prohibited from taping or recording communications, i.e. lectures or other academic events, with members or guests of the College unless given previous authorization. Designated administrative meetings and student hearings at the College may be recorded so long as the recording device is in plain view and everyone in attendance is aware that communications are being recorded. Administrative systems, such as voice mail, are also permitted. This section does not apply to monitoring or tape recording pursuant to a court order or other legitimate law enforcement activities (see Governor’s Executive Order, State of Utah, January 27, 1993).

DRC STATEMENT:

SLCC values inclusive learning environments and strives to make all aspects of the College accessible to our students. If you have a disability and believe you need accommodations to improve access to learning materials or the learning environment, please contact the Disability Resource Center: (phone) 801-957-4659; (email) drc@slcc.edu ; (website) www.slcc.edu/drc .

PREREQUISITE: Sewing

IMPORTANT PREREQUISITE & AUDIT INFORMATION: It is the student’s responsibility to examine each course description for details of prerequisite classes. Those prerequisites must be satisfied before the designated class may be taken. All prerequisite courses must be completed with a C or better grade in order to continue with the program. A student may be dropped from a class if the prerequisite has not been completed.

Not all Visual Art & Design (ART) classes may be audited. This is especially true for any VAD class that has a prerequisite. Students wishing to audit any VAD (ART) class without officially completing a prerequisite with a grade of C or better must

obtain signed permission from the instructor. VAD (ART) classes that do not have a prerequisite may be audited as per the Auditing Classes guidelines. Please see the SLCC General Catalog for more information.

VAD ATTENDANCE POLICY:

Students are expected to attend all classes in which they are enrolled on a regular and punctual basis. Failure to do so indicates that the student is not serious about Their education.

If, on occasion, a student must miss class he or she is responsible to acquire notes and assignments from another student. Networking with other students is highly recommended.

If a student has a serious illness or has another valid and compelling reason for being absent more than 20% of the class periods, he or she should talk to the instructor about receiving an “Incomplete” grade. The students should then be prepared to show documentation of the validity of the absences. Work for the class must then be completed within the next year or else the grade will become an “E.”

****It must be emphasized that domestic problems, job conflicts, other class or schedule conflicts, etc., are not considered valid and compelling reasons for non-attendance. Instructors are not allowed to give an “Incomplete” grade for these excuses.****

Students who are absent for more than approximately 20% of the class periods in a semester, and who do not have a valid, documented excuse, will receive an “E” grade for the course. To avoid this the student must officially withdraw from the class in the time frame outlined by the College.

If a student is tardy, it is his or her responsibility to notify the teacher of attendance before the class is over.

| Class Meets Per Wk. | Days Missed = E | NOTE: 3 Lates = 1 Absence |
|---------------------|-----------------|---------------------------|
| 1 | 3 | |
| 2 | 6 | |
| 3 | 9 | |
| 4 | 12 | |
| 5 | 15 | |

Example: A 3 Credit Hour Class Meeting 2 days per week.

For this class, missing the 6th day is considered an E grade.

INCOMPLETE: An incomplete is a conditional grade given only in extraordinary cases where a student has completed a major portion of the class but is unable to complete course work due to circumstances beyond their control such as major illness/injury or a death in the family. Written documentation from your physician will be required.

STUDENT TUTORING, COUNSELING, AND SUPPORT SERVICES:

General Learning Support & Tutoring Services provide support for SLCC students enrolled in any class at the College. All resources are provided free-of-charge. Ask your instructor about discipline specific learning support and tutoring services.

General Education: Regardless of your major, General Education courses build a foundation of broad knowledge and skills that help you in your further career and life. <http://www.slcc.edu/gened>

The Tutoring and Learning Centers provide free assistance in Math, Science, Accounting, CSIS and Allied Health Classes at 6 campus locations. <https://www.slcc.edu/tutoring>

The Student Writing Center provides in-person and online feedback on all writing assignments. <http://www.slcc.edu/swc>

The Academic Literacy Center provides tutoring in reading and conversation. <https://www.slcc.edu/english/academic-literacy-center.aspx>

Library Services provides research help, print and online resources, computers and study space. libweb.slcc.edu

The ePortfolio Lab provides drop-in assistance for all ePortfolio questions. <http://eportresource.weebly.com/>

Advising and Counseling Support Services provide support for students enrolled in any class at the college.

The Center for Health and Counseling provides health care, mental health counseling, massage therapy services and healthy lifestyle programs. <http://www.slcc.edu/chc/index.aspx>

Veterans' Services assists hundreds of students in using their VA education benefits each semester. <http://www.slcc.edu/veterans>

Academic and Career Advising helps students plan, explore, make decisions, access resources and evaluate their academic and career goals. And the Academic Achievement Center helps students achieve GPA requirements for graduation. <https://www.slcc.edu/academicadvising> <https://www.slcc.edu/academic-achievement-center/index.aspx>

UNIVERSITY OF FASHION:

We have a new resource available to all SLCC Fashion Institute students, a subscription to the to the University of Fashion. This subscription is a valuable supplemental information source.

Please be sure to sign up and take advantage of this departmental subscription by following the instructions below (you will need to use your SLCC Bruinmail to register):

Registration Process for University of Fashion

Subscribers will need to know if they are a new or a renewing member*, the Salt Lake Community College Code, if renewing, their password and they must use their school email address to successfully register.

*Renewing member is any person who has previously subscribed or entered their email into the University of Fashion website to view free videos. **Once an email is in the database you must renew your subscription versus signing up as a new member.**

1. Go to URL: <http://groups.universityoffashion.com/>
2. **New Members** – enter the code “SLCC2016” in the box under “Please enter your registration code”, click “Start Registration”, and follow the instructions. (see below)
3. **Renewing Members** - click “Need to renew? Click here if you have a new sign-up code and already have an account with University of Fashion Registered”, and follow the instructions on the next screen. (see below)

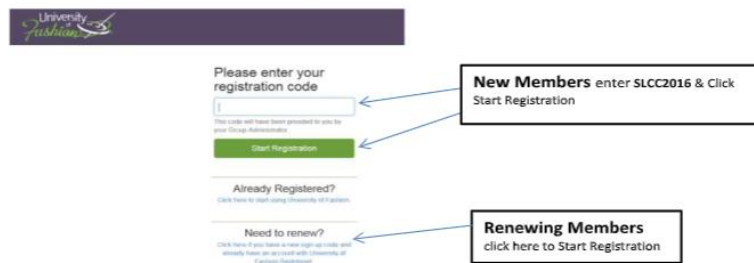

4. **Renewing Members** will be directed to page below. Complete the registration by entering the email, the password, and the SLCC2016 registration code. If members do not recall their password they can request a new one by clicking on “Forgot your password?”



Please contact mdorfman@universityoffashion.com with any registration issues.

Class Expectations:

- All of your Class assignments must be tried and balanced with all pieces fitting together smoothly and accurately: Right angles, smooth curves, equal matching seams, notches, complete darts, smooth continuous hems, seams, pre-miters etc.
- Every assignment, practical quiz and exam must be connected in a model (computer piece list) on YOUR C:Drive/Flash Drive.
- When your assignment is complete, the model as well as each individual piece must be submitted in the proper folder on MY P:Drive to be graded. Please Label them as discussed with your name.
- All Sewn assignments will be plotted full scale and must be sewn neatly; sewing is part of your grade. No puckered dart ends etc.
- Each sewn assignment must be accompanied by a completed technical spec sheet, and cutters must list (paper piece list) with flats of front and back (not illustrations).
- Learn to use the concepts in the book to think for yourself, and create well balanced patterns which fit well, are accurate, comfortable to wear, and easy to sew.
- As you learn, you may find a better way to do something. This IS acceptable, as long as you achieve the desired outcome. Please share your method with the class.
- Most of the time when it seems like the computer is malfunctioning; it is because you are not reading the prompts on the screen. You have a single point out of place, or 2 lines that don't touch. Zoom in and find them, fix them, then move on. Don't keep pushing the button too many times without letting the computer catch up, if you do it will freeze.
- Save often! If you get stuck in one place go over the instructions carefully one at a time. Read the computer response.
- If you are still stuck, skip it and move on to the next part. Doing the same thing over and over, the same way, expecting a different result IS the definition of insanity. Don't go there. Bring your questions in for class Q & A. You will have fun once you figure it out. I am here to help.
- Your participation is key to the success and enjoyment of this course.
- You must come to class prepared – having done the required homework, study and practice. There is open lab time available. Stay and use it. Plan time to practice. The software we use is only available in this room (404). You will need to plan enough time in the room to complete your lessons and assignments.
- Attendance: Simply put, you are required to be here. Attendance is part of your grade.
- Assignments: We will begin assignments in class as demonstrations. You will have to complete assignments outside of class when necessary.
- Plan to sew your assignments into samples weekly. Plotting is planned for Thursdays so that you have a few days to have them sewn for Tuesdays.
- Quizzes: Please be prepared for random written canvas or practical quizzes.
- If there is something specific you would like to learn, related to our class, please ask.